

Ideal to lift garden machinery, golf carts and mini tractors.

Provides easy access to reels and hydraulic systems.

**OVERHEAD CABLE EQUALIZATION** for unobstructed floor surface.

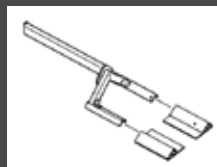

Wheel adapter kit to raise vehicles with less than 330 mm wheels.



**THE DUAL CONTROL PANELS** - one on each side of the lift - ensure that you have complete control no matter where you're standing, streamlining your workflow and enhancing efficiency.



**ADJUSTABLE DRIVE-OVER RAMPS AND SIDE RAILS** provide the width to support wider vehicles during approach.

Wheel engaging chocks wheels automatically.

Lift can accommodate both **3-WHEEL** (1100 kg) **AND 4-WHEEL** (2300 kg) **TURF EQUIPMENT.**



**ELECTRO-HYDRAULIC  
2-POST LIFTS**

**TLO7**

## TECHNICAL DATA

	<b>TLO7</b>
	<b>ROT.TLO7T.199676</b>
<b>Capacity</b>	1100 - 2300 kg
<b>Number of columns</b>	2
<b>Column layout</b>	symmetrical
<b>Mode of drive</b>	electrohydraulic
<b>Control</b>	on both sides
<b>Energy kit</b>	standard
<b>Type of installation</b>	surface-mounted
<b>Max. lifting height</b>	1803 mm
<b>Lifting time</b>	45 s
<b>Lowering time</b>	40 s
<b>Cylinder height at max. stroke</b>	3778 mm
<b>Clear span between</b>	2915 mm
<b>Drive-through width</b>	2324 mm
<b>Switchoff level</b>	4032 mm
<b>Min. ceiling height</b>	4200 mm
<b>Wheelbases wheel alignment</b>	762 - 2235 mm
<b>Arm layout</b>	asymmetrical
<b>Driving power</b>	3 kW
<b>Power Supply</b>	230/400 V   50 Hz
<b>Phases</b>	3 Ph
<b>Width</b>	3496 mm
<b>Height</b>	4166 mm
<b>Weight</b>	980 kg

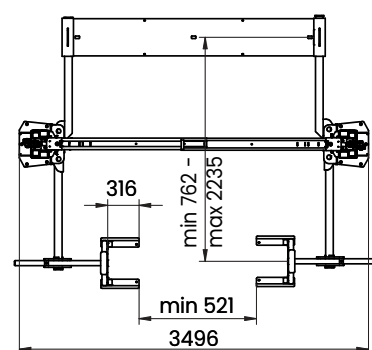
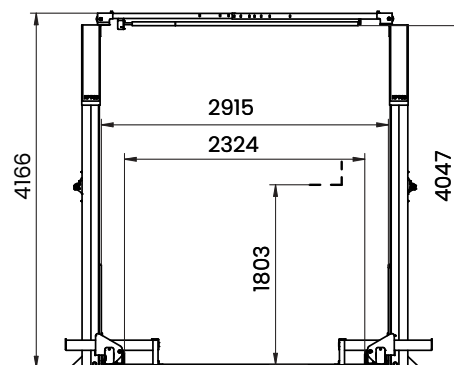

Technical changes reserved. Data are considered advertisement.



GERMANY **BlitzRotary GmbH** Hüfanger Straße 55 | 78199 Bräunlingen | +49 771 9233 0  
 ITALY **Vehicle Service Group Italy S.r.l.** Via F. Brunelleschi 9 | 44020 Ostellato FE | +39 051 6781511  
 FRANCE **RAV France SARL** 4, Rue De Longue Raie, ZAC de la Tremblaie | 91220 Le Plessis Pâté | +33 1 60 86 88 16  
 UK **Vehicle Service Group UK Ltd** 3 Fourth Avenue, Bluebridge Industrial EST | Halstead, Essex, CO9 2SY | +44 1787 477711

a **DOVER** company

✉ [info.emea@rotarysolutions.com](mailto:info.emea@rotarysolutions.com)

 [ROTARYsolutions.eu](http://ROTARYsolutions.eu)