

DETAIL X

Wasserabfluss DN100 in der Vertiefung empfohlen
Wateroutlet DN 100 in the pit recommended

Betonqualität
quality of concrete
min.C20/25
normal bewehrt
normal armouring

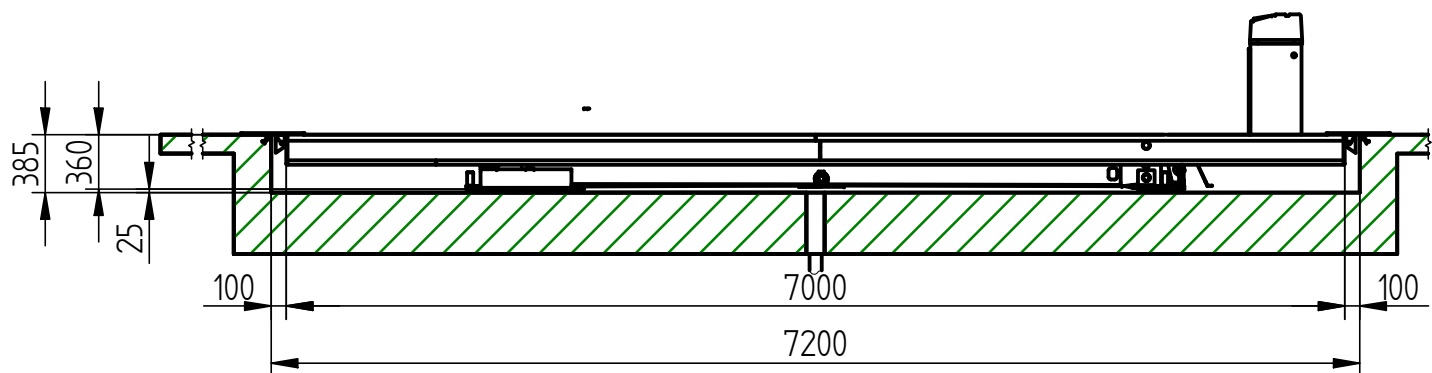

Bedienpult
operating unit

Bauseits am Bedienpult bereitstellen:
Netzanschluss: 3PH+PE,400V,50Hz
Motorleistung: 3,5 kW
Absicherung: 10 Ampere träge
Kabellänge: ca.2m, 4 x 4mm²

Wir weisen in unseren Plänen auf die Mindestanforderung des Fundamentes hin, jedoch der Zustand der örtlichen Gegebenheiten (z.B. Untergrund, Ausführung etc.) obliegt nicht unserer Verantwortung. Die Ausbildung der Einbausituation muss vom planenden Architekten bzw. Statiker im speziellen Fall individuell spezifiziert werden.

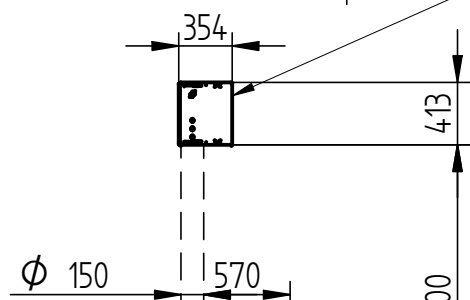

Prepared by customer at the main operating unit:
power supply: 3PH+PE,400V,50Hz
Motor power 3,5kW
fuse: 10 Ampere, time lag
cable diameter: 4 x 4mm²
cable length: approx.2m

We point out the minimum requirement of the foundation in our plans. The condition of the local realities for example: the ground under the foundation) does not lie in our responsibility. The execution of the installation situation must be individually specified by the planning architect or by the engineer engaged in statically calculations in the special case.

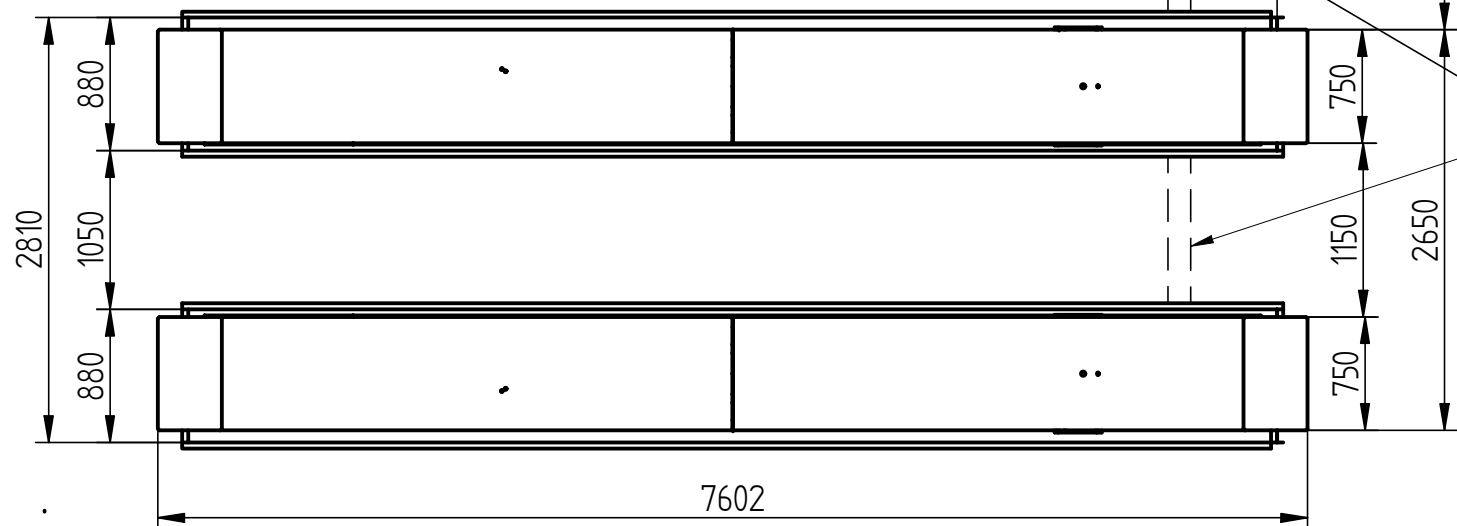

Kabelkanal
cable channel

Alle Maße in Millimeter
all dimensions in millimeter

Maß- und Konstruktionsänderungen vorbehalten!
subject to alterations!

				THIRD ANGLE PROJECTION		S130-701 Data sheet	
				UNLESS OTHERWISE NOTED: ANGULAR DIMENSIONS: +/- 1 OTHER DIMENSIONS: +/- 0.8mm (< 305mm) +/- 1.6mm (> or= 305mm)			
				NOTES: Tragfähigkeit/capacity: 13000 kg			
				The design and detail illustrated in this drawing is the property of Vehicle Service Group. It is being loaned with the expressed condition that it will not be duplicated or used except by permission and is subject to return upon request.			
REV	CO NUM	DATE	BY	DRAWN MD.		DATE 29.07.2021	SHEET
				APPROVED		DRAWING NUMBER S130-701_059507470	